

# DECLARATION OF PERFORMANCE

DoP number: 133050-A5W1111

Product name:

Blauwrood Genuanceerd HV EF

Identification code of product-type is DoP-number



Wienerberger B.V.

Hogeweg 95 - 5301 LK Zaltbommel

Netherlands

Intended use in masonry walls, columns and partitions for:

Assessment and verification of constancy of performance:

Harmonised standard:

Notified body/ies:

unprotected masonry

System 2+

EN 771-1:2011+A1:2015

0957

## Declared performance/s of a U - masonry unit

### Dimensions and tolerances

			T2	R1
Length:	mm	213	± 4	9
Width:	mm	101	± 3	6
Height:	mm	65	± 2	5
Tolerance:	category	T2		
Range:	category	R1		
Flatness of bed faces:	mm	NPD		
Plane parallelism:	mm	NPD		
Configuration				
Group of the unit:	-	1		
Volume of all formed voids:	%	NPD		
Volume of frogs:	%	< 20		

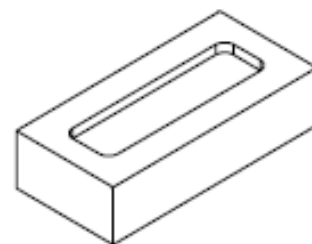

actual configuration may vary slightly

### Density

Gross dry density:	kg/m <sup>3</sup>	1700
Net dry density:	kg/m <sup>3</sup>	NPD
Tolerance:	category / %	D1 / 10

### Compressive strength for Category I product

Perpendicular to bedface:	N/mm <sup>2</sup>	20
Perpendicular to header:	N/mm <sup>2</sup>	NPD
Perpendicular to header 2:	N/mm <sup>2</sup>	NPD
Bond strength:	N/mm <sup>2</sup>	NPD

Thermal conductivity  $\lambda_{10}$ , dry, unit: W/(m·K) 0.45 *Determination method EN 1745:2012: S1*

Water vapour permeability: -  $\mu = 5/10$

Durability: category F2

Water absorption: % 12

Initial rate of water absorption: kg/(m<sup>2</sup>·min) 1-5

Active soluble salt content: category S2

Moisture movement: mm/m NPD

Reaction to fire: class A1 *(EU 96/603/EC)*

Dangerous substances: - NPD

The performance of the product identified above is in conformity with the set of declared performance/s. This declaration of performance is issued, in accordance with Regulation (EU) No 305/2011, under the sole responsibility of the manufacturer identified above.

Signed for and on behalf of the manufacturer by:

2020-07-23 CEO

B.J. Koekoek

Wienerberger B.V.  
Hogeweg 95 - 5301 LK Zaltbommel  
Netherlands