

DECLARATION OF PERFORMANCE

DoP number: 12450950-B1W1245

Product name:

JASMINE BLEND

Identification code of product-type is DoP-number



Wienerberger NV
Kapel ter Bede - 8500 Kortrijk
Belgium

Intended use in masonry walls, columns and partitions for:
Assessment and verification of constancy of performance:
Harmonised standard:
Notified body/ies:

unprotected masonry
System 2+
EN 771-1:2011+A1:2015
0749

Declared performance/s of a U - masonry unit

| Dimensions and tolerances | | | T1 | R1 |
|--|--------------------------|--------------|-----|----|
| Length: | mm | 240 | ± 6 | 9 |
| Width: | mm | 115 | ± 4 | 6 |
| Height: | mm | 71 | ± 3 | 5 |
| Tolerance: | category | T1 | | |
| Range: | category | R1 | | |
| Flatness of bed faces: | mm | NPD | | |
| Plane parallelism: | mm | NPD | | |
| Configuration | | | | |
| Group of the unit: | - | 1 | | |
| Volume of all formed voids: | % | NPD | | |
| Volume of frogs: | % | < 20 | | |
| Density | | | | |
| Gross dry density: | kg/m ³ | 1550 | | |
| Net dry density: | kg/m ³ | 1600 | | |
| Tolerance: | category / % | D1 / 10 | | |
| Compressive strength for Category I product | | | | |
| Perpendicular to bedface: | N/mm ² | 25 | | |
| Perpendicular to header: | N/mm ² | NPD | | |
| Perpendicular to header 2: | N/mm ² | NPD | | |
| Bond strength: | N/mm ² | NPD | | |
| Thermal conductivity λ_{10} ,dry,unit: | W/(m·K) | 0.69 | | |
| Water vapour permeability: | - | $\mu = 5/10$ | | |
| Durability: | category | F2 | | |
| Water absorption: | % | 17 | | |
| Initial rate of water absorption: | kg/(m ² ·min) | 1-5 | | |
| Active soluble salt content: | category | S2 | | |
| Moisture movement: | mm/m | NPD | | |
| Reaction to fire: | class | A1 | | |
| Dangerous substances: | - | NPD | | |

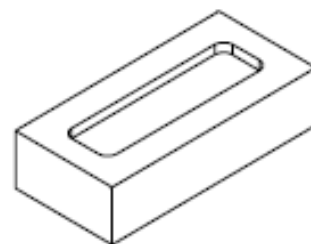

actual configuration may vary slightly

The performance of the product identified above is in conformity with the set of declared performance/s. This declaration of performance is issued, in accordance with Regulation (EU) No 305/2011, under the sole responsibility of the manufacturer identified above.

Signed for and on behalf of the manufacturer by:

2020-08-04 CEO Caroline Van De Velde

Wienerberger NV
Kapel ter Bede - 8500 Kortrijk
Belgium