

# DECLARATION OF PERFORMANCE

DoP number: 12450650-B1W1245

Product name:

NF KASTANIE

Identification code of product-type is DoP-number



Wienerberger NV  
Kapel ter Bede - 8500 Kortrijk  
Belgium

Intended use in masonry walls, columns and partitions for:  
Assessment and verification of constancy of performance:  
Harmonised standard:  
Notified body/ies:

unprotected masonry  
System 2+  
EN 771-1:2011+A1:2015  
0749

## Declared performance/s of a U - masonry unit

| Dimensions and tolerances                       |                          |          | T1  | R1 |
|---|--------------------------|----------|-----|----|
| Length:   | mm                       | 240      | ± 6 | 9  |
| Width:  | mm                       | 115      | ± 4 | 6  |
| Height:   | mm                       | 71       | ± 3 | 5  |
| Tolerance:                                      | category                 | T1       |     |    |
| Range:  | category                 | R1       |     |    |
| Flatness of bed faces:                          | mm                       | NPD      |     |    |
| Plane parallelism:                              | mm                       | NPD      |     |    |
| Configuration                                   |                          |          |     |    |
| Group of the unit:                              | -                        | 1        |     |    |
| Volume of all formed voids:                     | %                        | NPD      |     |    |
| Volume of frogs:                                | %                        | < 20     |     |    |
| Density   |                          |          |     |    |
| Gross dry density:                              | kg/m <sup>3</sup>        | 1650     |     |    |
| Net dry density:                                | kg/m <sup>3</sup>        | 1700     |     |    |
| Tolerance:                                      | category / %             | D1 / 10  |     |    |
| Compressive strength for Category I product     |                          |          |     |    |
| Perpendicular to bedface:                       | N/mm <sup>2</sup>        | 25       |     |    |
| Perpendicular to header:                        | N/mm <sup>2</sup>        | NPD      |     |    |
| Perpendicular to header 2:                      | N/mm <sup>2</sup>        | NPD      |     |    |
| Bond strength:                                  | N/mm <sup>2</sup>        | NPD      |     |    |
| Thermal conductivity λ <sub>10,dry,unit</sub> : | W/(m·K)                  | 0.69     |     |    |
| Water vapour permeability:                      | -                        | μ = 5/10 |     |    |
| Durability:                                     | category                 | F2       |     |    |
| Water absorption:                               | %                        | 14       |     |    |
| Initial rate of water absorption:               | kg/(m <sup>2</sup> ·min) | 3-8      |     |    |
| Active soluble salt content:                    | category                 | S2       |     |    |
| Moisture movement:                              | mm/m                     | NPD      |     |    |
| Reaction to fire:                               | class                    | A1       |     |    |
| Dangerous substances:                           | -                        | NPD      |     |    |

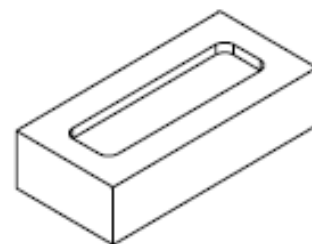

actual configuration may vary slightly

The performance of the product identified above is in conformity with the set of declared performance/s. This declaration of performance is issued, in accordance with Regulation (EU) No 305/2011, under the sole responsibility of the manufacturer identified above.

Signed for and on behalf of the manufacturer by:

2020-07-22 CEO Caroline Van De Velde

Wienerberger NV  
Kapel ter Bede - 8500 Kortrijk  
Belgium