

# DECLARATION OF PERFORMANCE

DoP number: 122490-A4W1124

Product name:

Fortuna WS VF

Identification code of product-type is DoP-number



# Wienerberger

Wienerberger B.V.  
Hogeweg 95 - 5301 LK Zaltbommel  
Netherlands

Intended use in masonry walls, columns and partitions for:  
Assessment and verification of constancy of performance:  
Harmonised standard:  
Notified body/ies:

unprotected masonry  
System 2+  
EN 771-1:2011+A1:2015  
0957

## Declared performance/s of a U - masonry unit

Dimensions and tolerances			T1	Rm
Length:	mm	210	± 6	20
Width:	mm	100	± 4	10
Height:	mm	40	± 3	10
Tolerance:	category	T1		
Range:	category	Rm		
Flatness of bed faces:	mm	NPD		
Plane parallelism:	mm	NPD		
Configuration				
Group of the unit:	-	1		
Volume of all formed voids:	%	NPD		
Volume of frogs:	%	≤ 20		
Density				
Gross dry density:	kg/m <sup>3</sup>	1600		
Net dry density:	kg/m <sup>3</sup>	NPD		
Tolerance:	category / %	D1 / 10		
Compressive strength for Category I product				
Perpendicular to bedface:	N/mm <sup>2</sup>	20		
Perpendicular to header:	N/mm <sup>2</sup>	NPD		
Perpendicular to header 2:	N/mm <sup>2</sup>	NPD		
Bond strength:	N/mm <sup>2</sup>	NPD		
Thermal conductivity λ <sub>10,dry,unit</sub> :	W/(m·K)	0.41	Determination method EN 1745:2012: S1	
Water vapour permeability:	-	μ = 5/10		
Durability:	category	F2		
Water absorption:	%	15		
Initial rate of water absorption:	kg/(m <sup>2</sup> ·min)	1-5		
Active soluble salt content:	category	S2		
Moisture movement:	mm/m	NPD		
Reaction to fire:	class	A1		
Dangerous substances:	-	Voldoet aan Bbk		

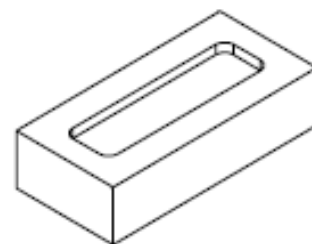

actual configuration may vary slightly

The performance of the product identified above is in conformity with the set of declared performance/s. This declaration of performance is issued, in accordance with Regulation (EU) No 305/2011, under the sole responsibility of the manufacturer identified above.

Signed for and on behalf of the manufacturer by:

2022-07-07 CEO

B.J. Koekoek

Wienerberger B.V.  
Hogeweg 95 - 5301 LK Zaltbommel  
Netherlands